

THIS DRAWING MAY BE USED ONLY FOR THE PURPOSE INTENDED AND ONLY WRITTEN DIMENSIONS SHALL BE USED

**NOTES**

1. PROPOSED CARRIAGEWAY TO BE A MINIMUM WIDTH OF 7m
2. FOOTWAY TO BE A MINIMUM WITH OF 3m.

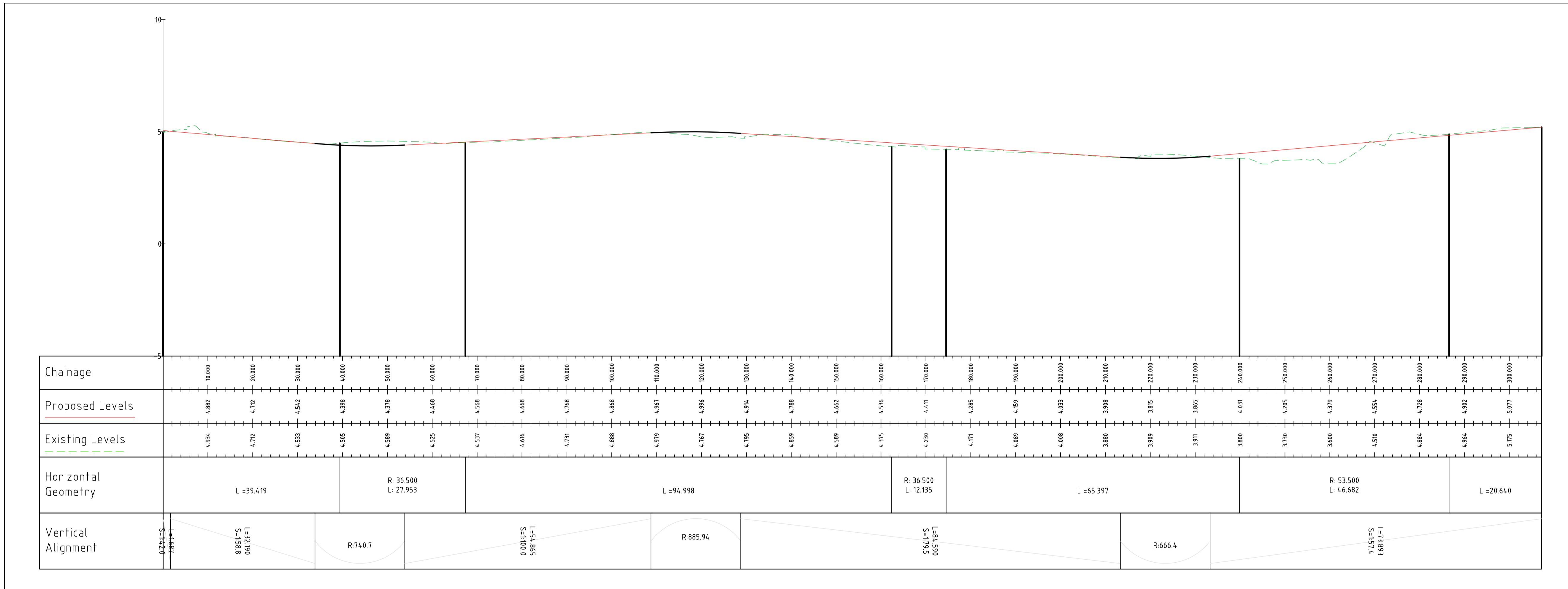

Revision Details	By	Date	Suffix
	Check		

Drawing Status  
**PLANNING**

Job Title  
**EFW CHP FACILITY  
NORTH YARD DEVONPORT**

Drawing Title  
**SITE  
ACCESS  
LONG SECTION**

Scale at A1  
H: 1:500 V: 1:100

Drawn	Approved
CM	GNB
Stage 1 check	Stage 2 check
Originated	Date
	11/04/11

Drawing Number  
**PA19B**



Plot Date :  
AutoCAD File Name :

DB1V